

Fastime 9X app instructions



The Fastime 9X pairs via Bluetooth with the app, enabling coaches to create detailed athlete profiles, share exercise data via Excel, and capture photo/video evidence of finishes directly from their device.



Bluetooth Pairing with Smartphones

1. Download the Merun app
2. Ensure Bluetooth on your phone and Fastime 9X are on. Under Clock mode, press and hold C to turn Bluetooth on and see 4 digit code.
3. Bind your device by opening the app, press settings, click 'My Device' then 'Search'. Select the watch's 4 digit code.
4. Your devices are now paired.



iPhone download



Android download

Operating the Stopwatch with Video or Camera

Keep Bluetooth connected.

To take a video

To take an image of the finish line and times:

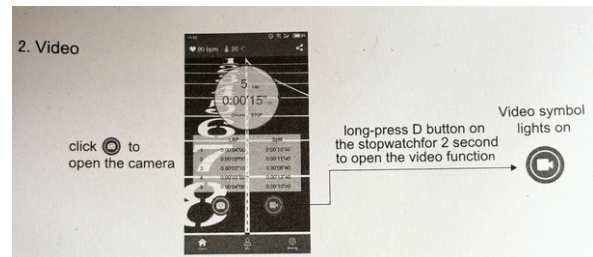
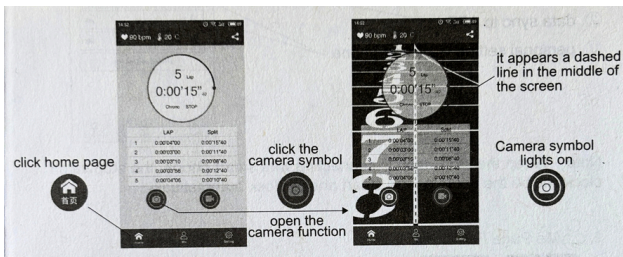

Install the phone on a tripod and adjust the position to line up the dashed line in the phone screen with the track's sprint line to catch a clear image.

10 seconds before the first athlete crosses the line, open the video function on the app. Fastime 9X should be on lap/split function. The camera will automatically record video of the finish line (approx 2 seconds) before and after.

Email: info@astopwatch.co.uk

Call: +44(0)7483 134 796

FASTIME

Fastime 9x instructions continued

Data Sync

On the stopwatch, press **C** to stop timing. Press **A** to reset and store memory segment. This will automatically turn camera/video off.

Select 'Data Sync' on the app. Note stopwatch and stroke rate timing must both be stopped and reset to 0 before sync can perform.



App Functions

1. Home Page Function

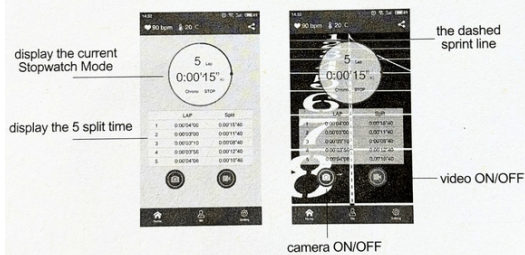

2. Setting Page Function



Note : When the stopwatch is connecting with smart phone, the stopwatch clock will be the same as the smart phone clock automatically.

3. Me Page Function

1. Stopwatch + Rowing

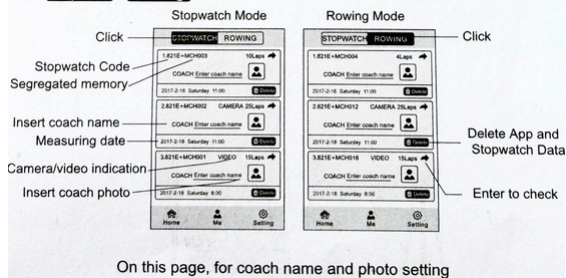

2. Stopwatch

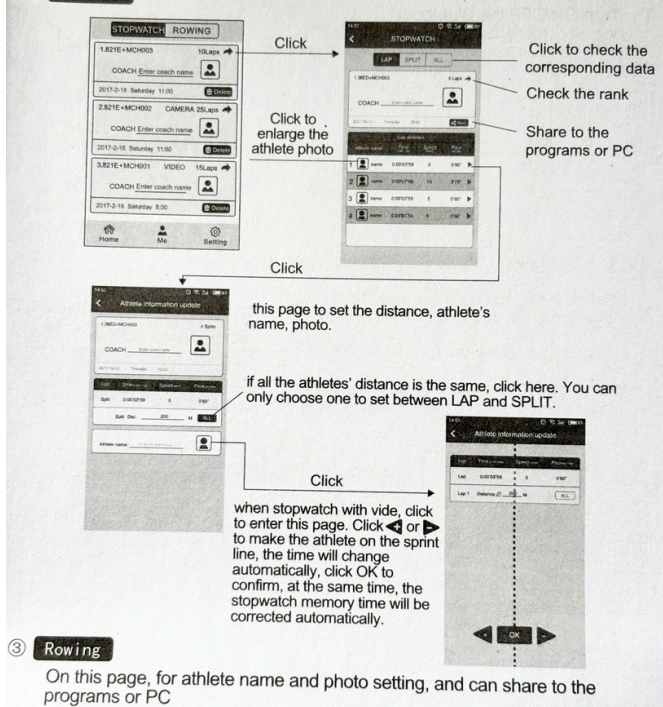

3. Rowing

On this page, for athlete name and photo setting, and can share to the programs or PC